

ELOfleet Process to Manage Drained Phone Battery

This process is required to restart the ELOfleet phone after the phone battery is completely drained (e.g., when the vehicle battery is disconnected for more than one week).

STEP 1: Reconnect the vehicle battery to the vehicle. The ELObox will begin to recharge the ELOfleet phone automatically.

STEP 2: **WAIT 10–15 MINUTES** for the ELOfleet phone to partially recharge.

STEP 3: Press and hold the ELOfleet phone's power button (on the side of the phone) to turn the phone on.

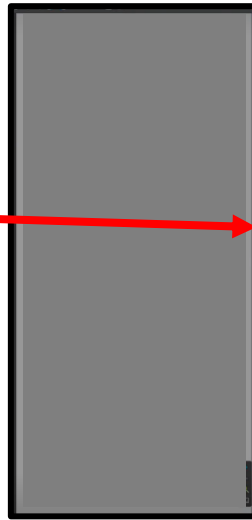

The phone should power on and display its home screen.

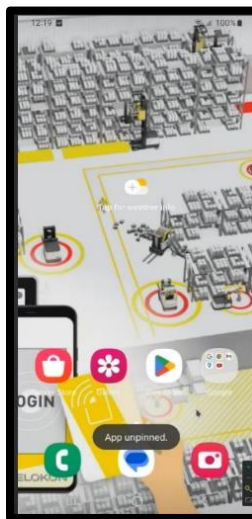

STEP 4: If necessary, swipe the phone screen to go to the screen that displays the ELOfleet app icon.

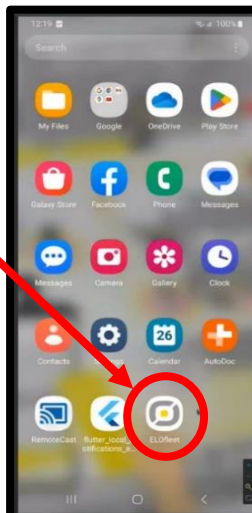

STEP 5: Tap the ELOfleet app icon to launch the app.

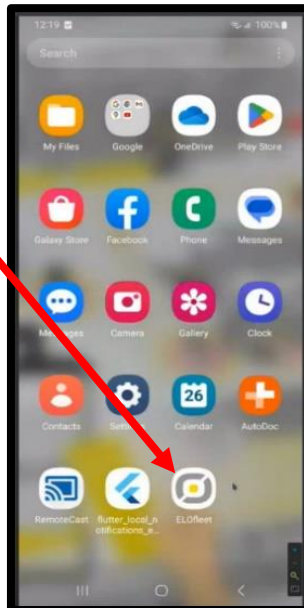

STEP 6: After the ELOfleet app launches, tap the OK button to "pin" the app.

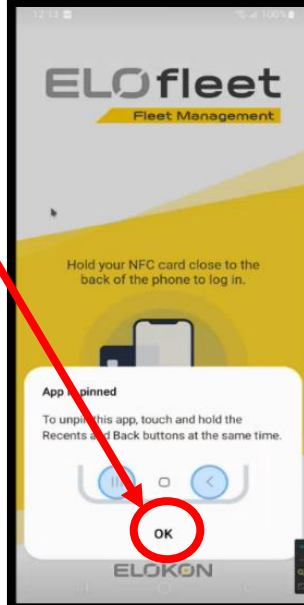

The ELOfleet app should return to normal, and vehicle operators should be able to log in.

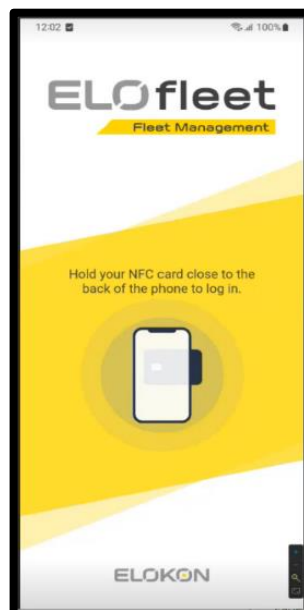

END OF ELOfleet PROCESS TO MANAGE DRAINED PHONE BATTERY